

Befestigen Sie die obere Schiene.

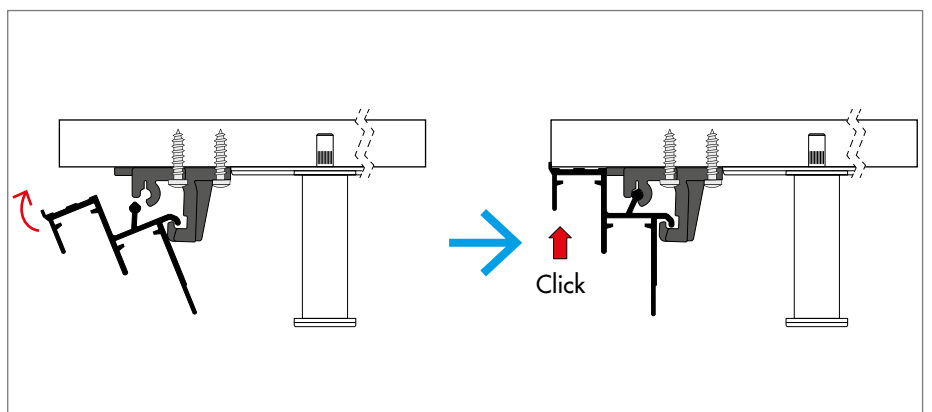

L = R

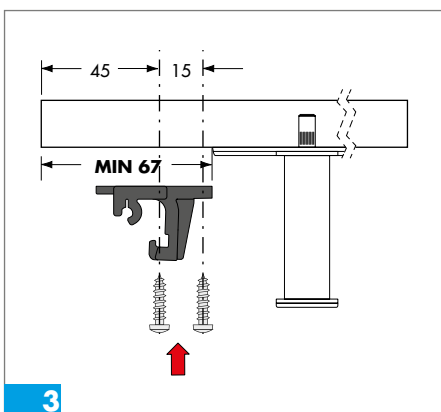
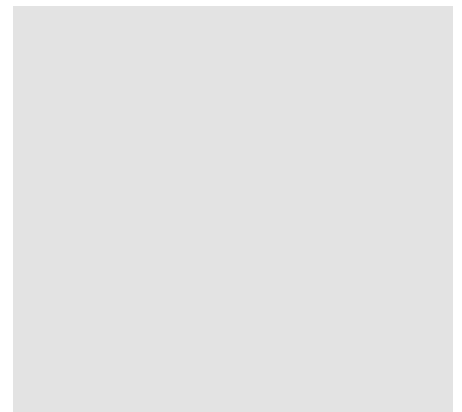
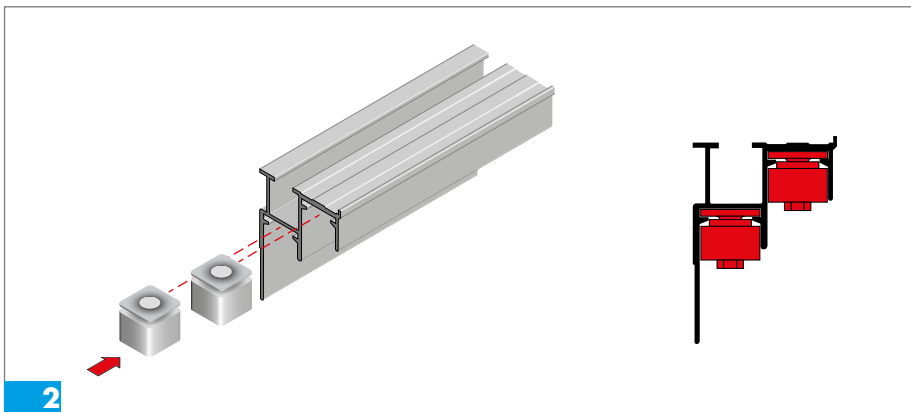
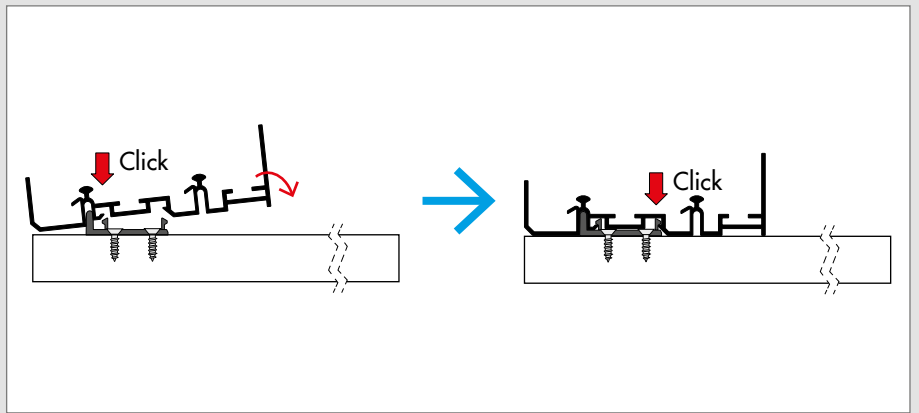
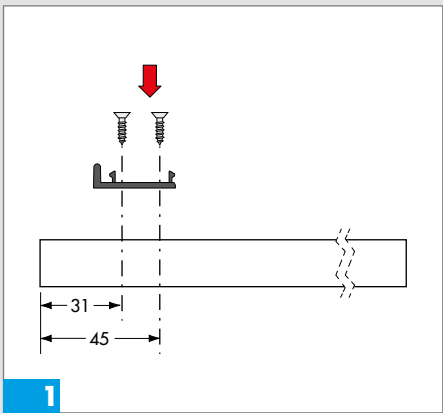
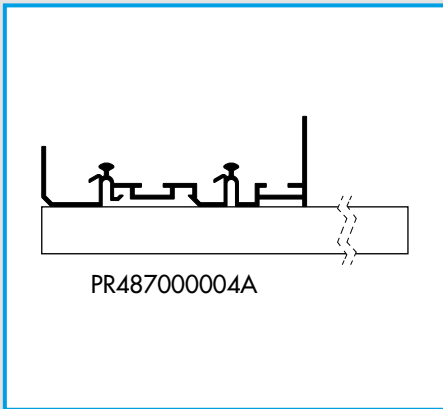
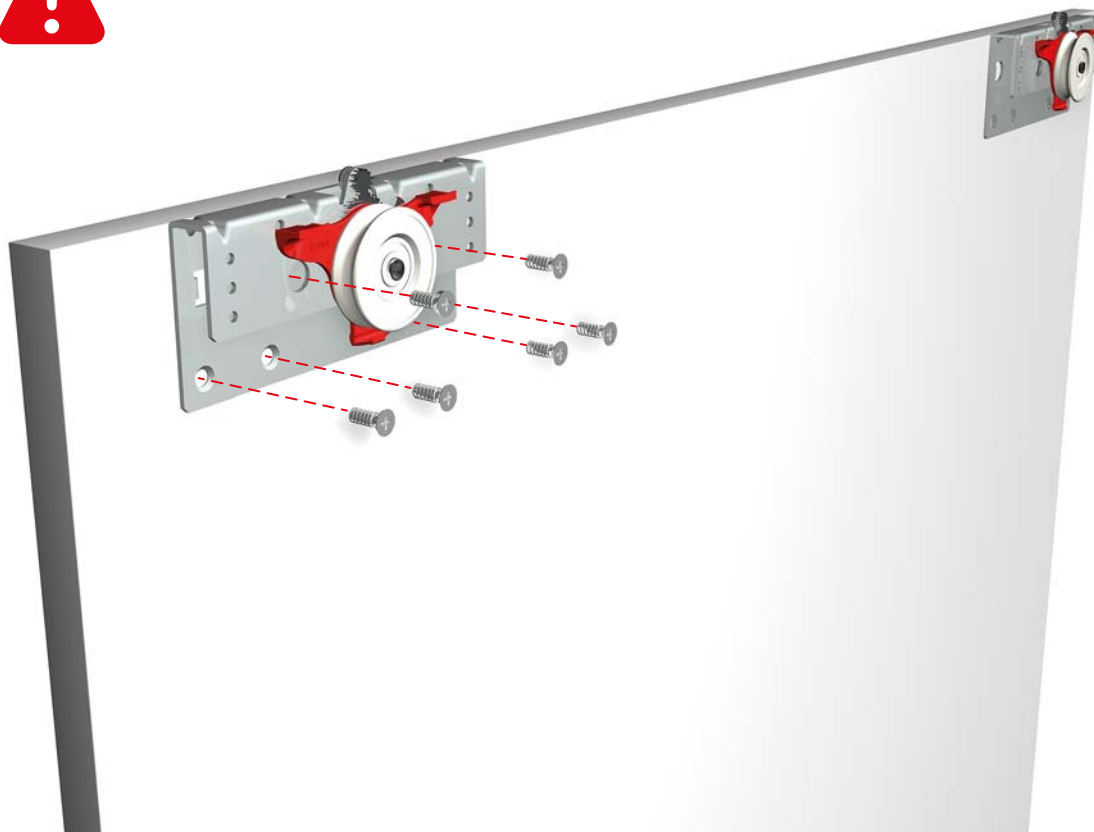

4

L = R

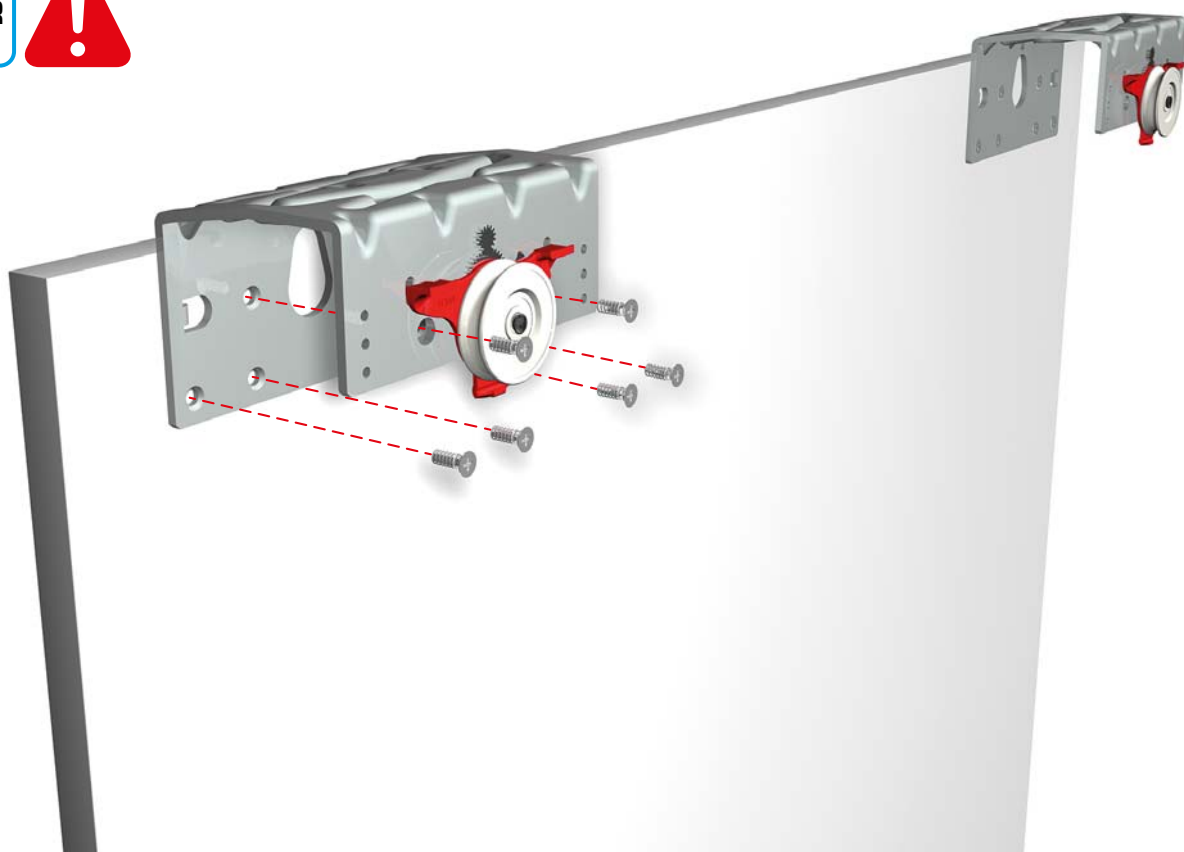

5

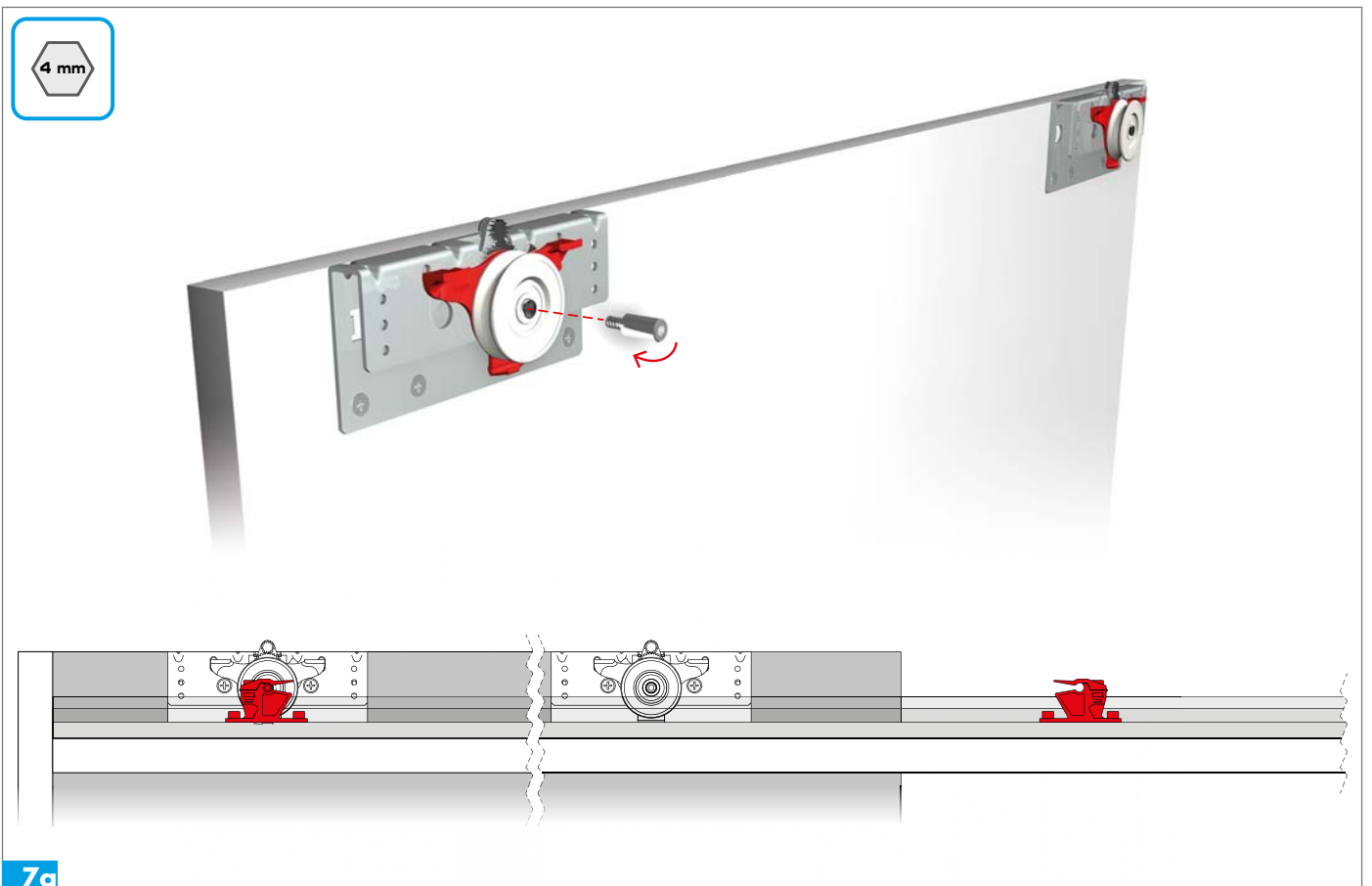
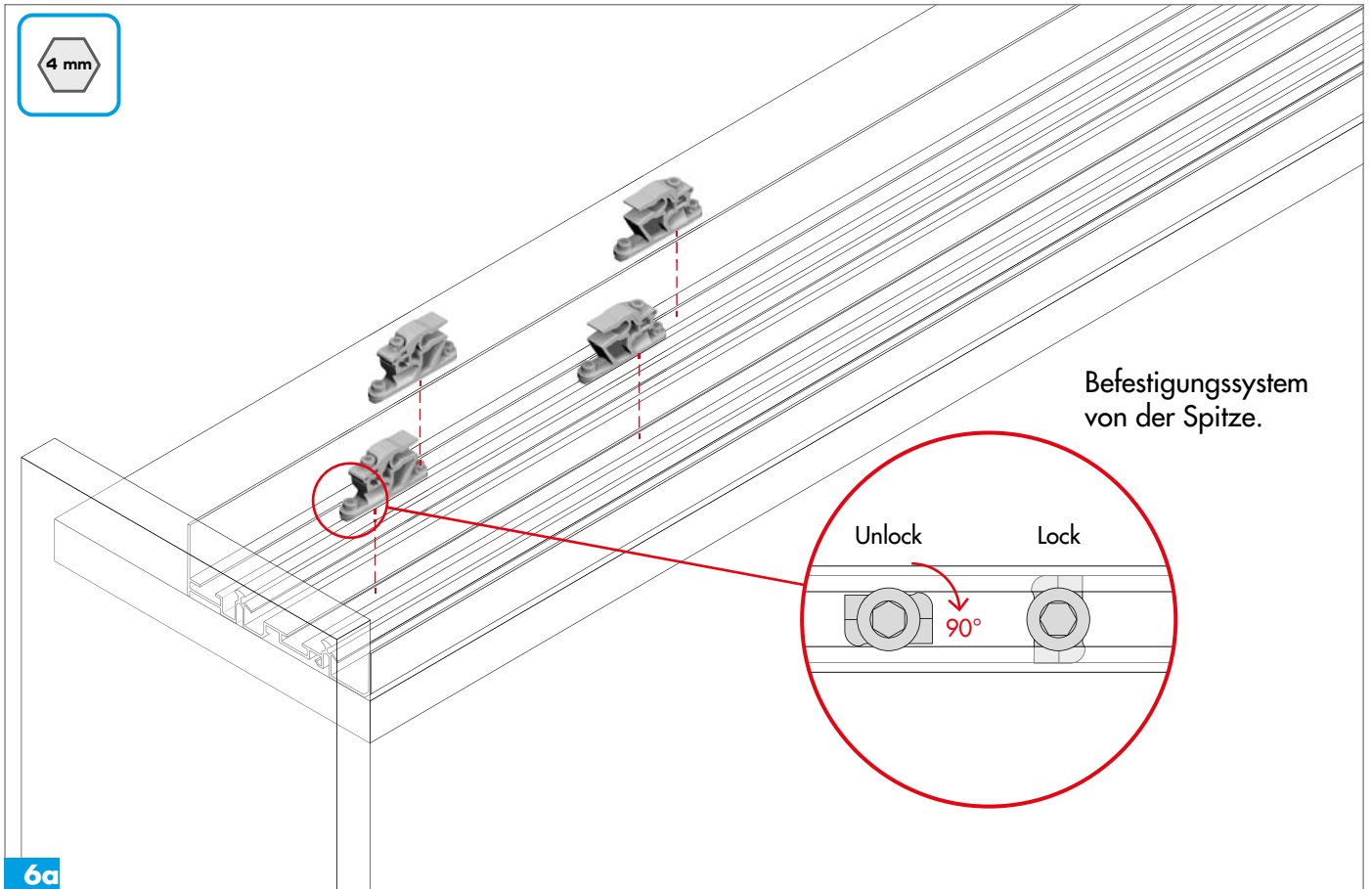

4 mm

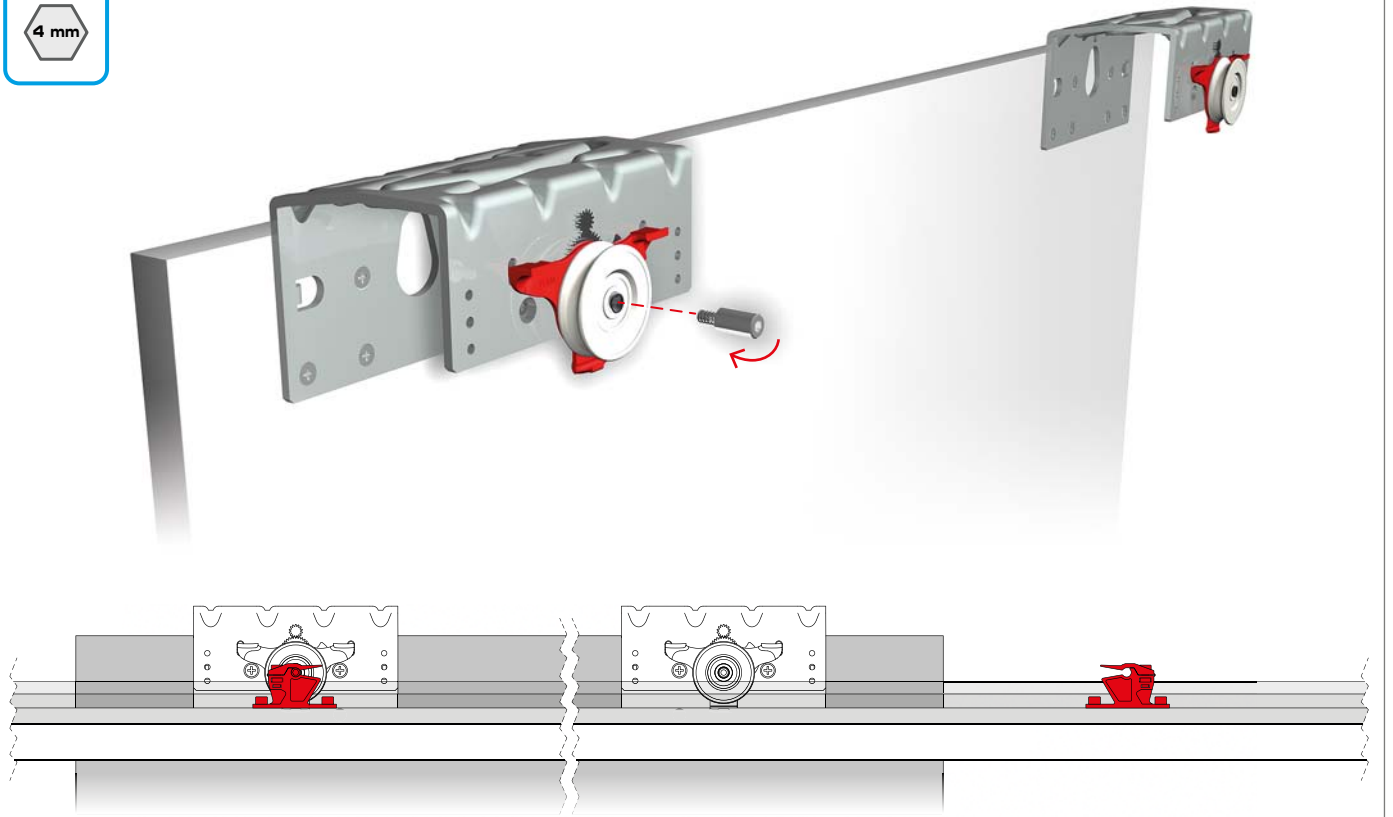

8a

Positionierung der obere Aufschläge

A

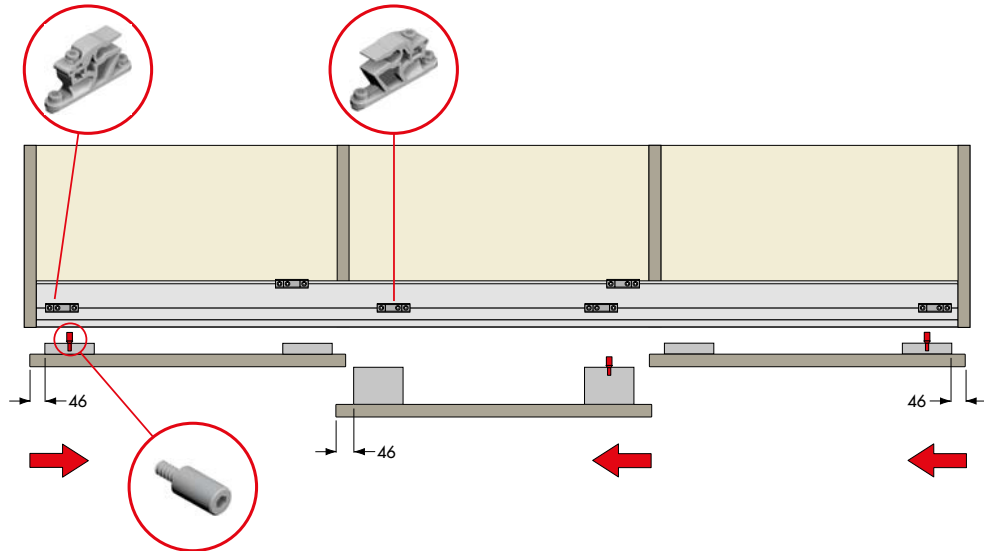

B

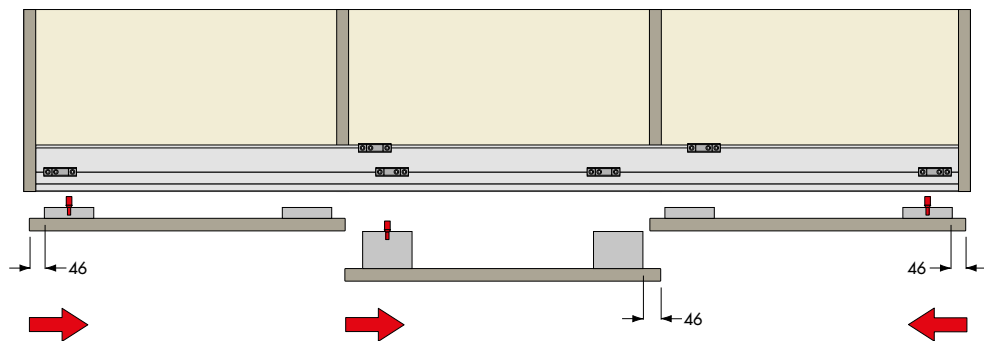

C

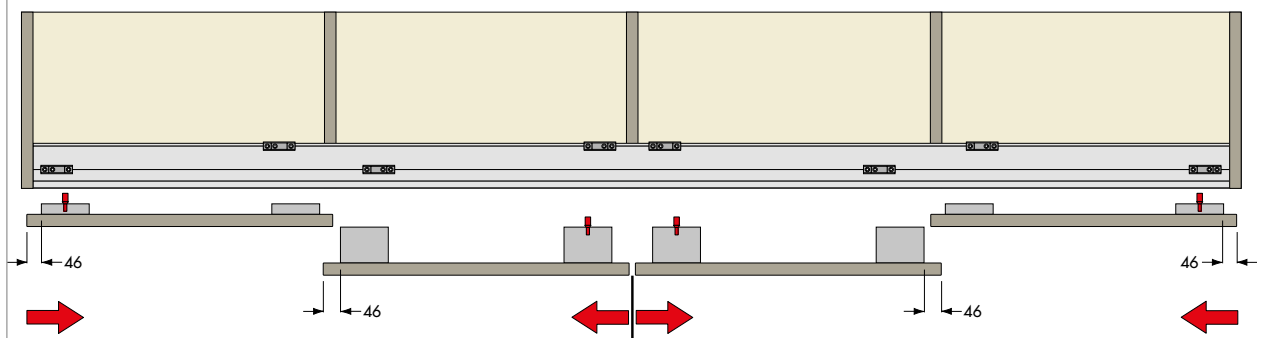

4 mm

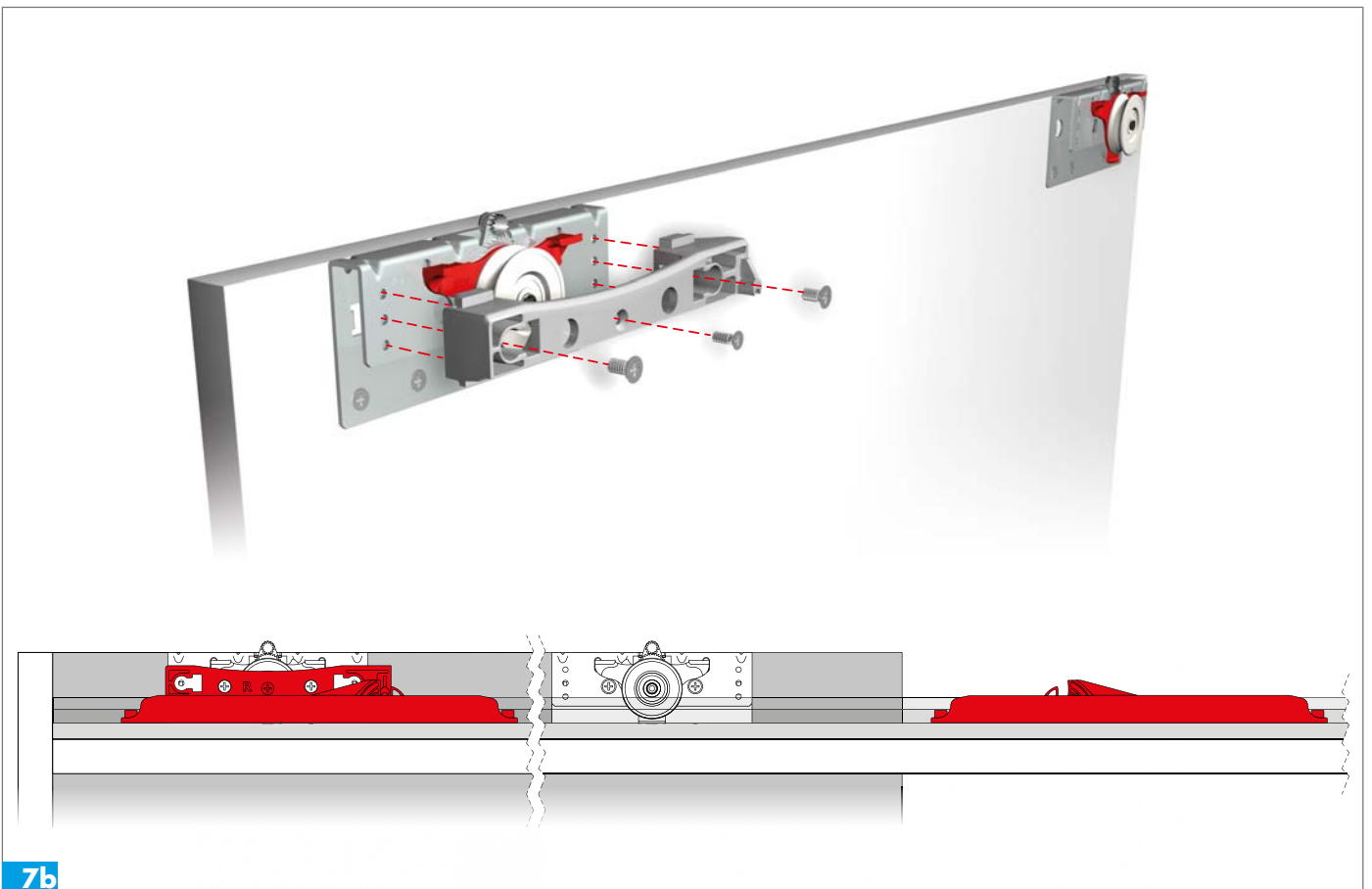
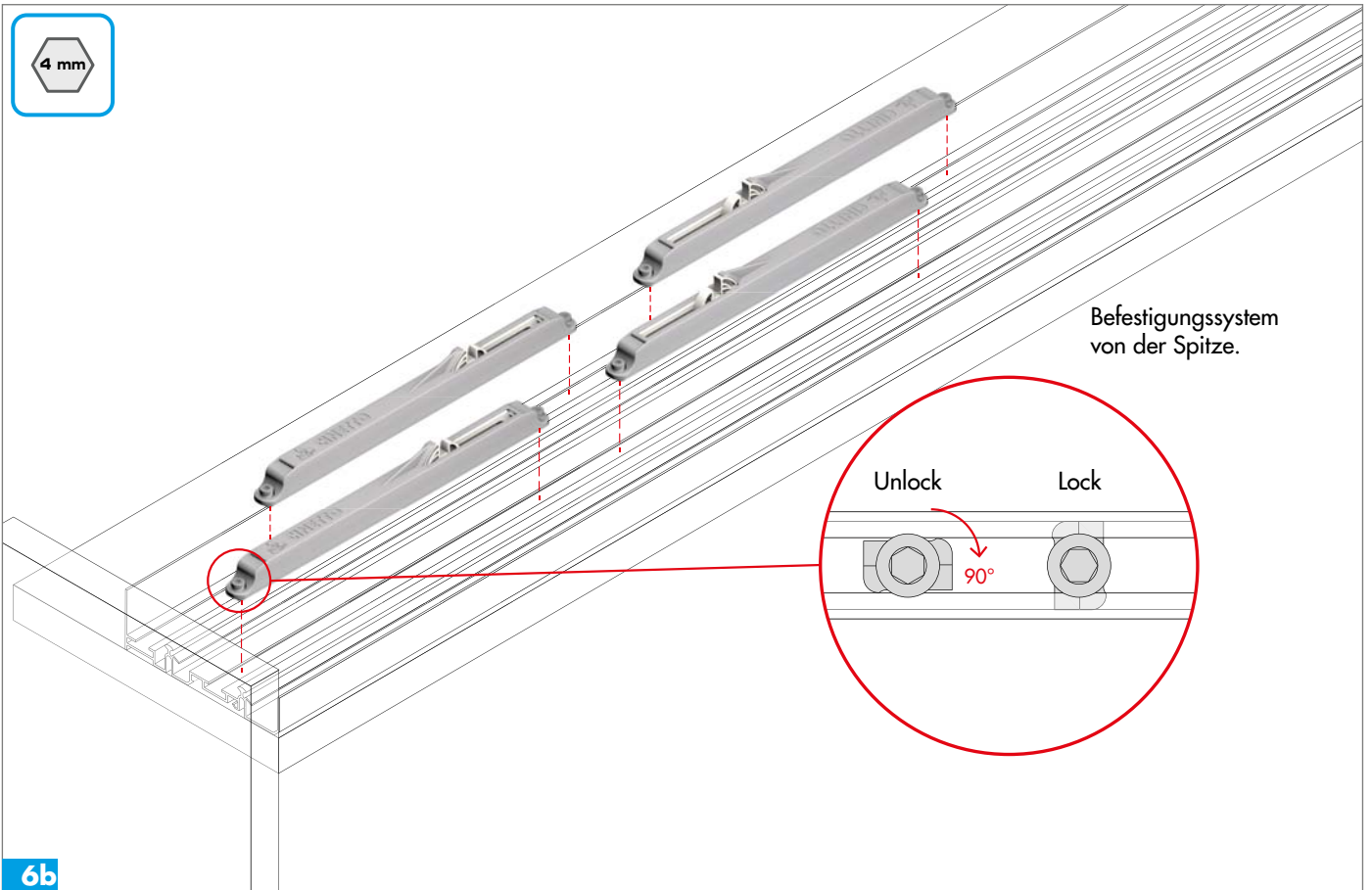

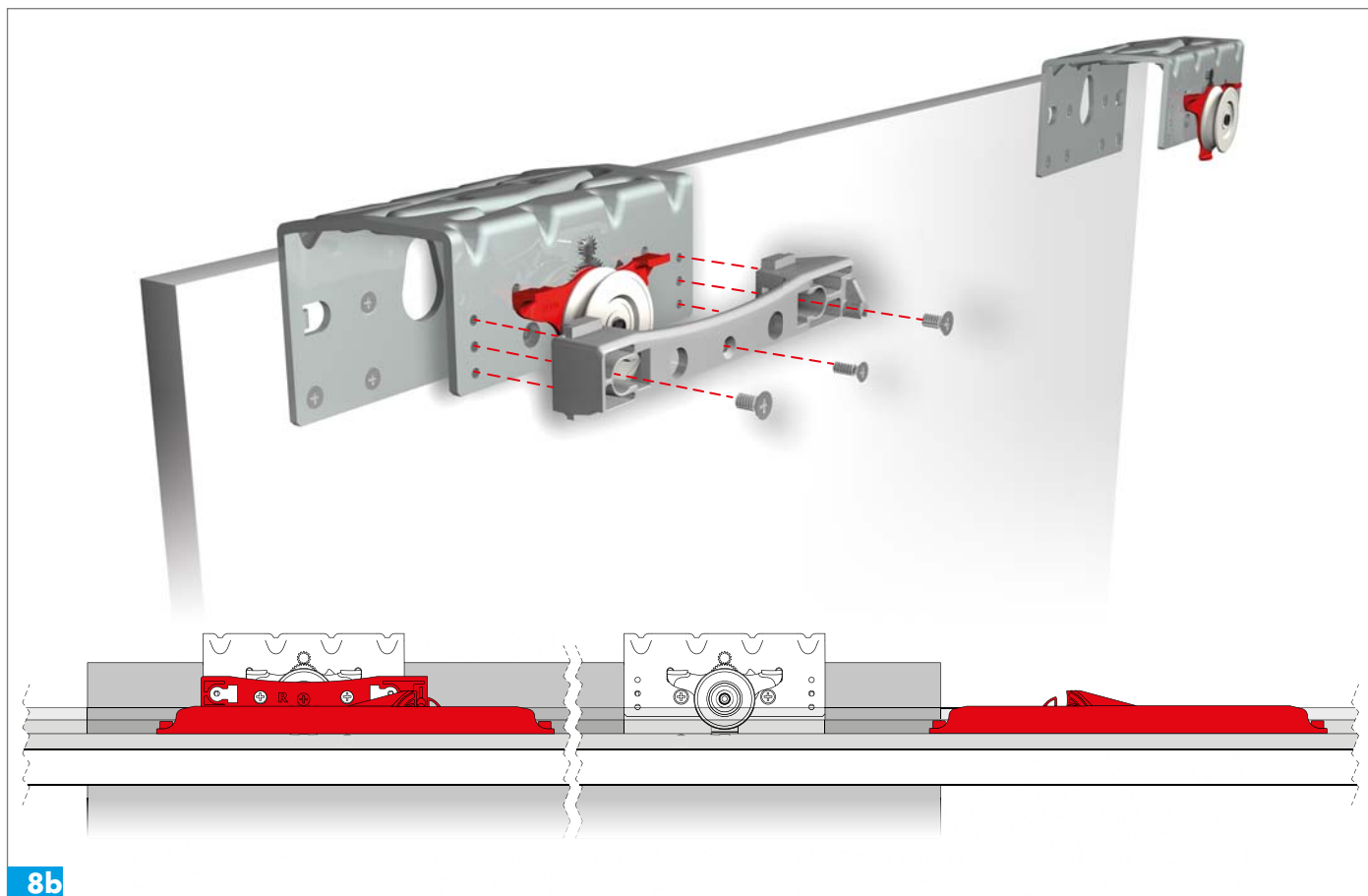



Schemen zur Positionierung des Dämpfungssystems und der Aktivatoren.

A

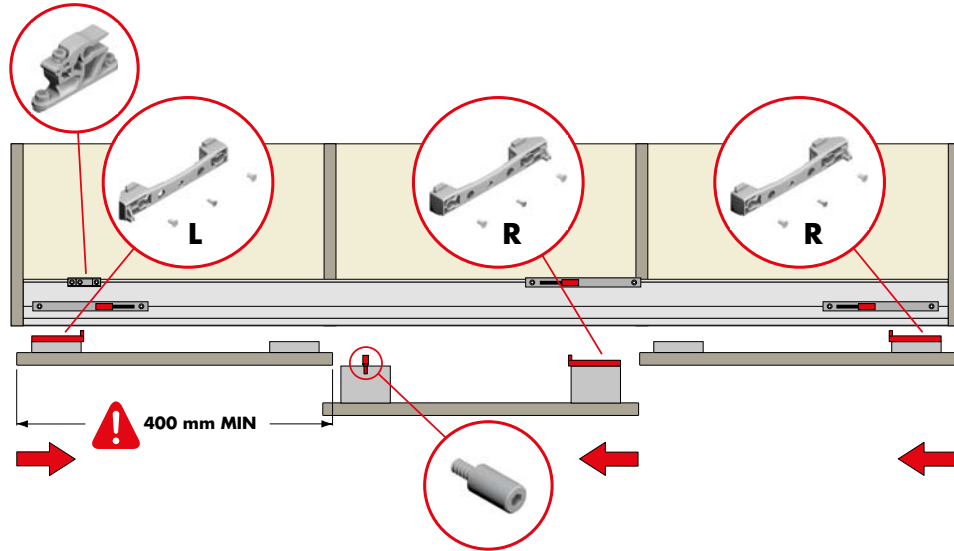

B

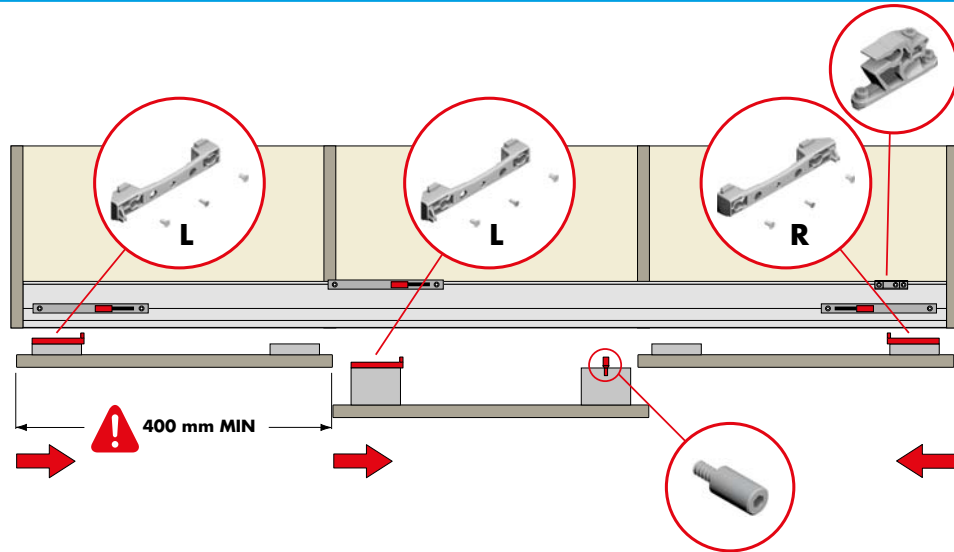

C

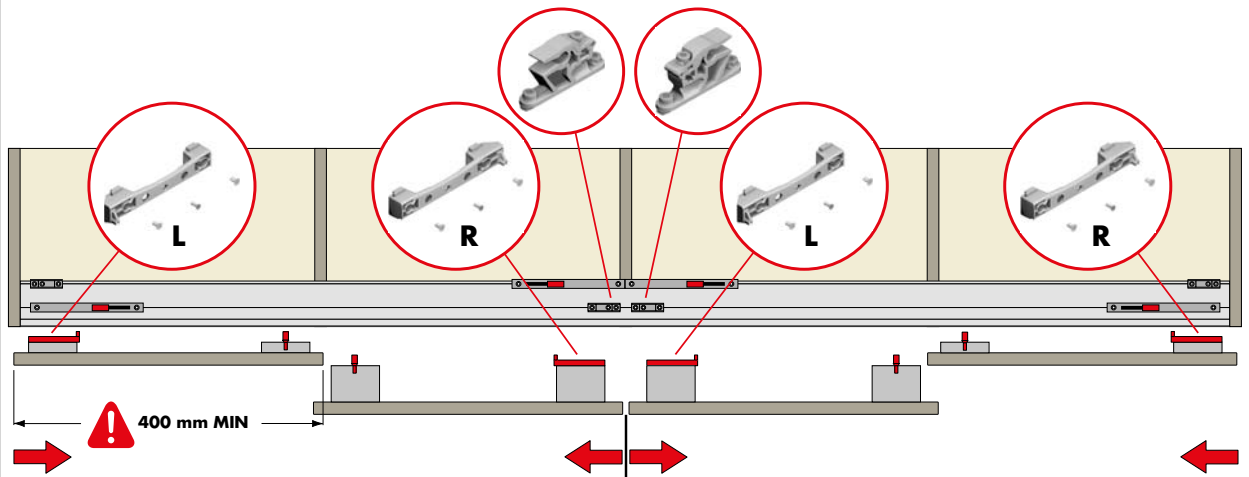

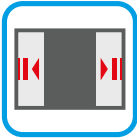

Schemen zur Positionierung des Dämpfungssystems und der Aktivatoren.

A

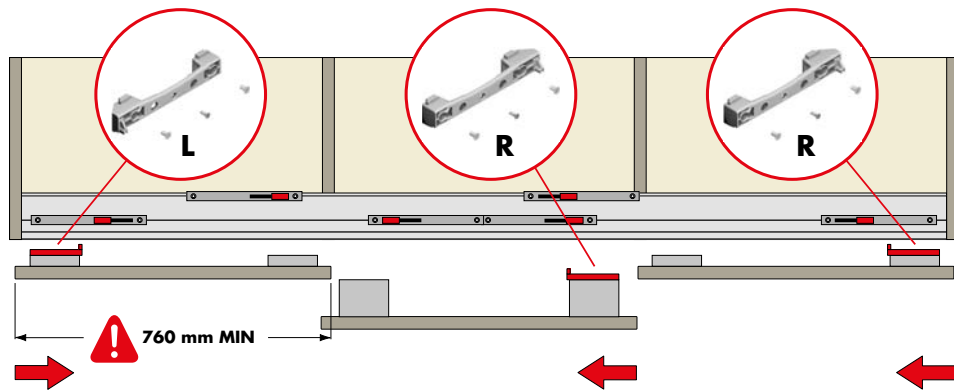

B

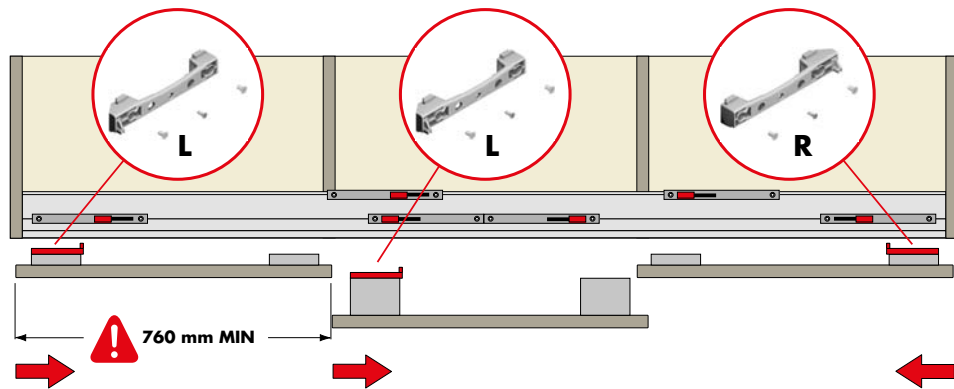

C

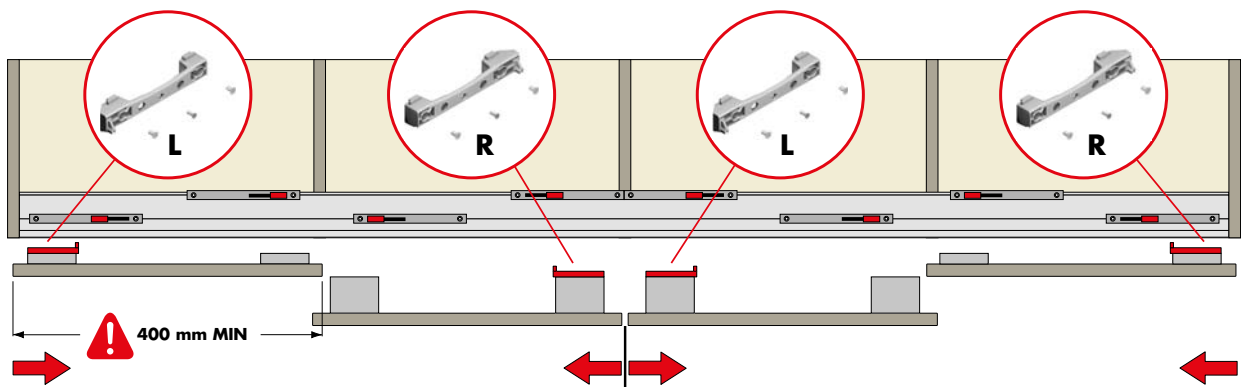

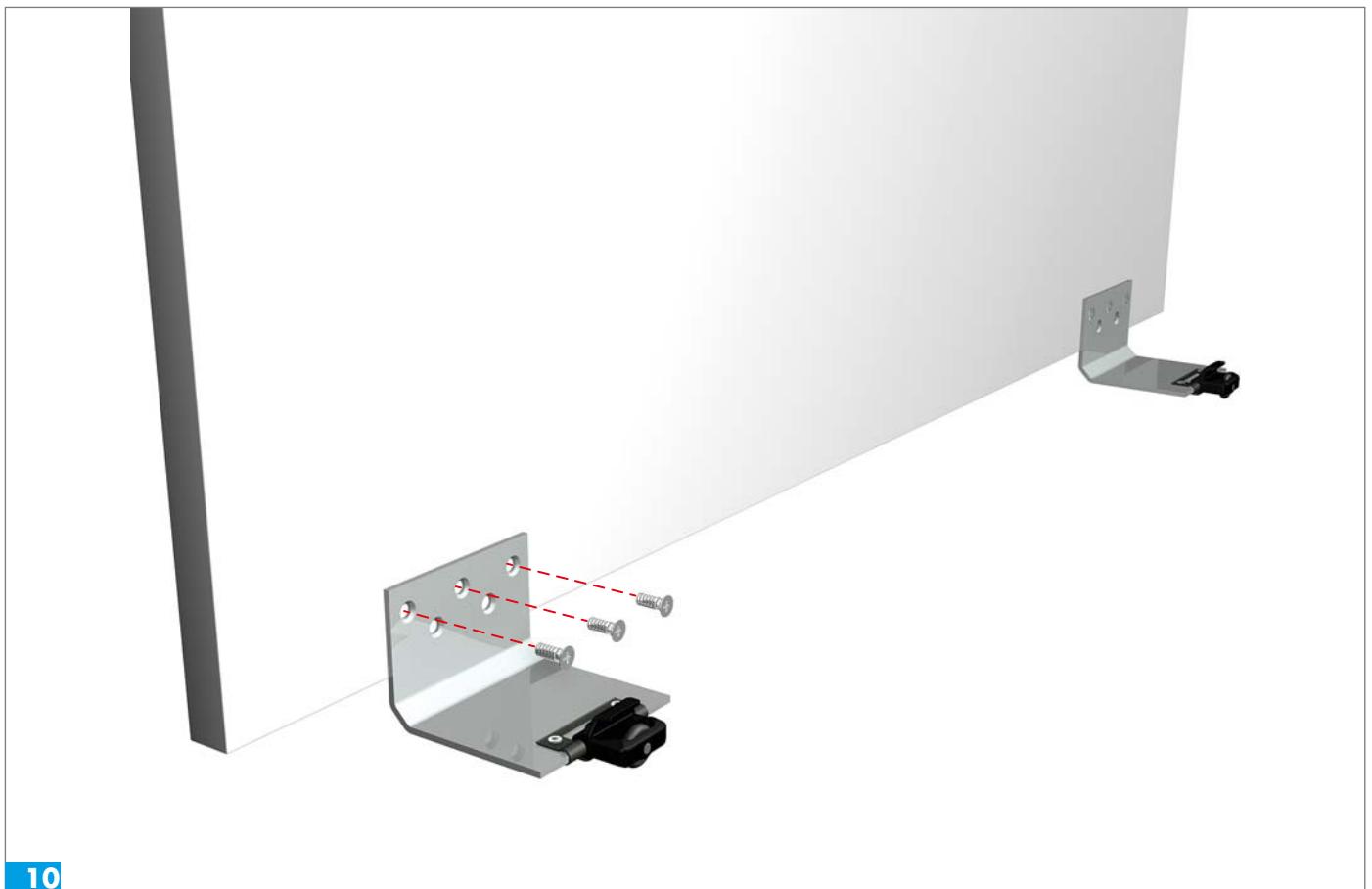
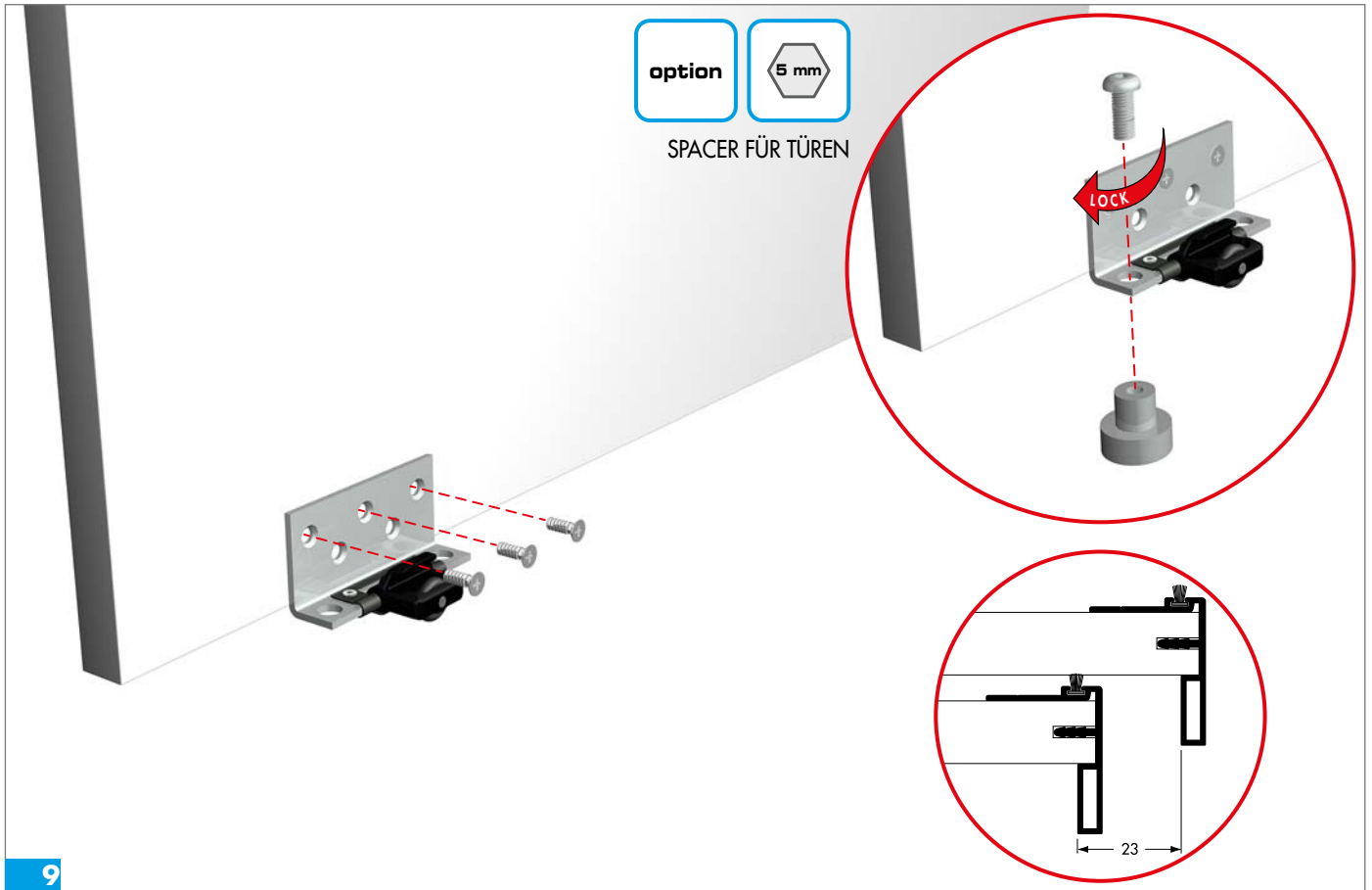

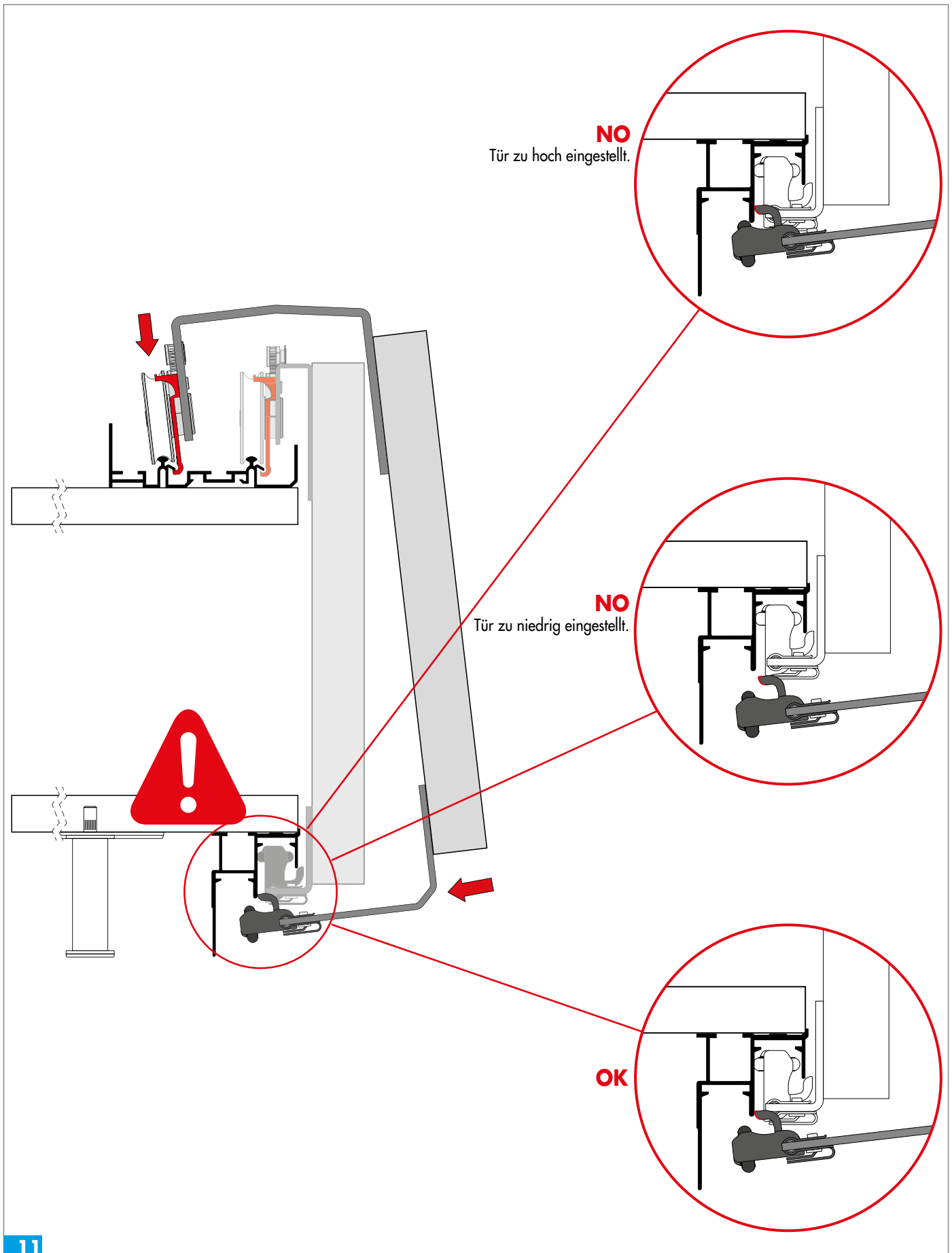

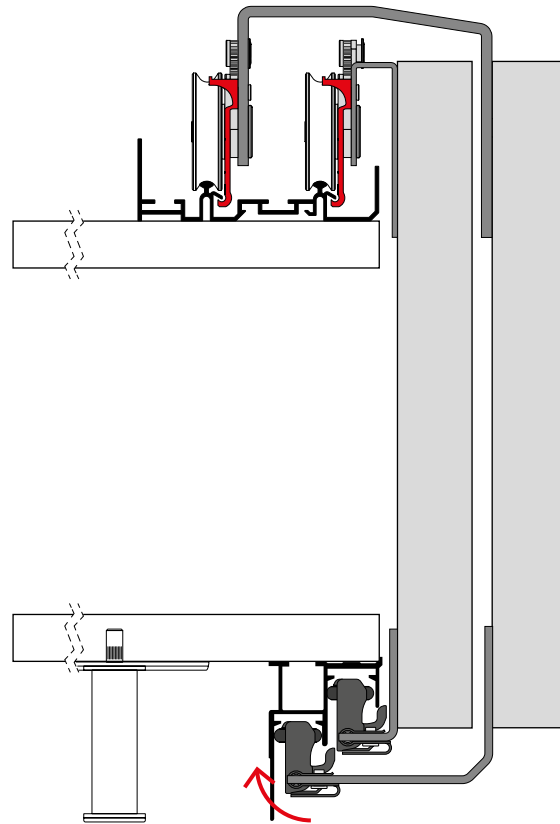

12

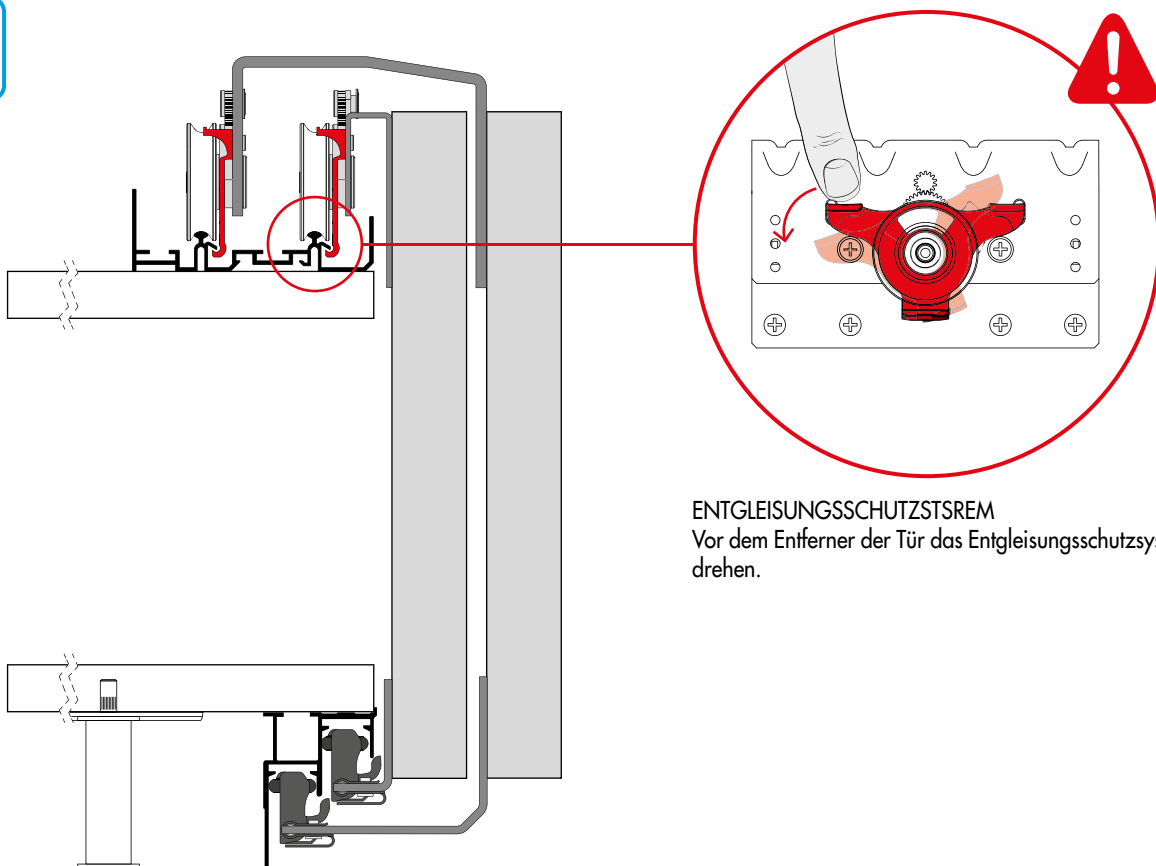

ENTGLEISUNGSSCHUTZSTREM
Vor dem Entfernen der Tür das Entgleisungsschutzsystem drehen.

13

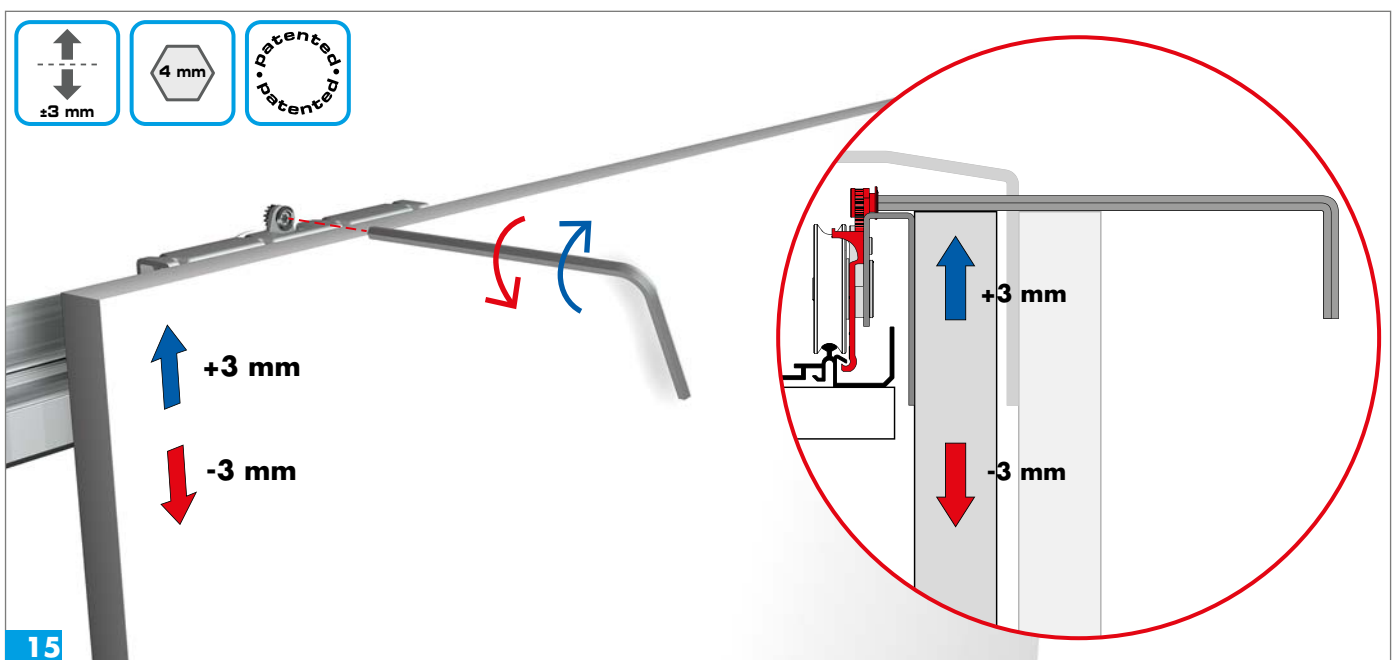
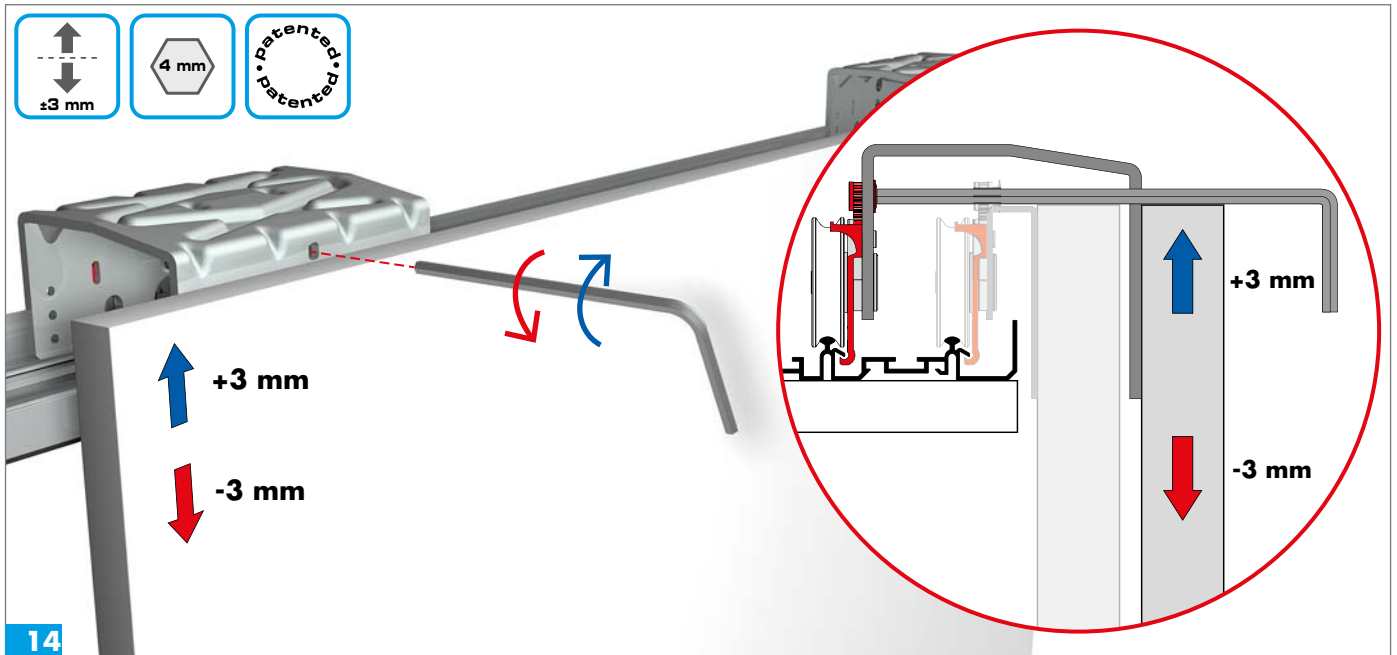

Die Tür schließen und den unteren Anschlag hinlegen.

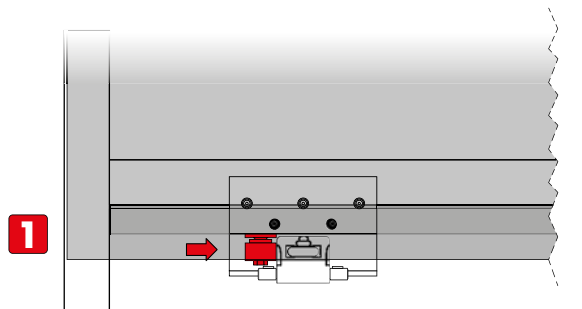

Die Tür aufmachen und den unteren Anschlag hinlegen.

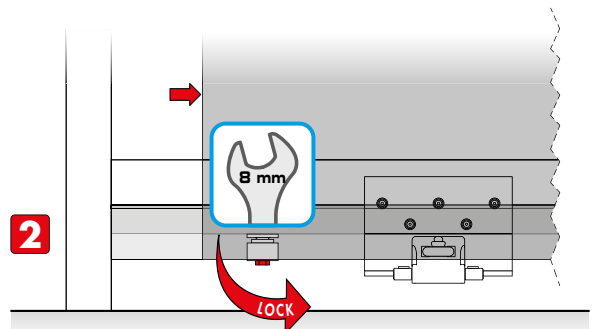

16



No Softspace

Die Tür schließen und den oberen Anschlag hinlegen.

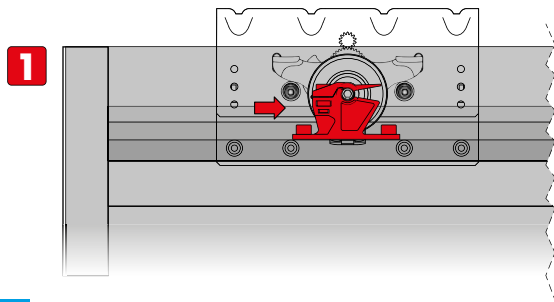

Den oberen Anschlag befestigen.

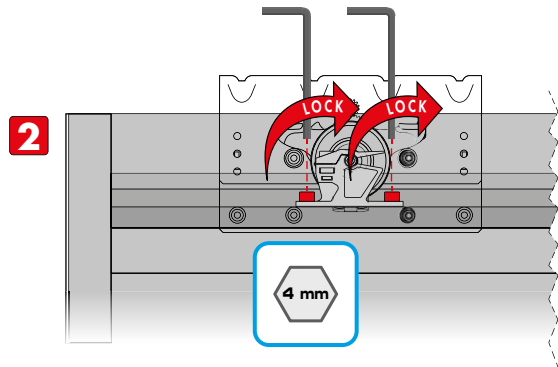

17a



Die Tür schließen und den Dämpfer legen.

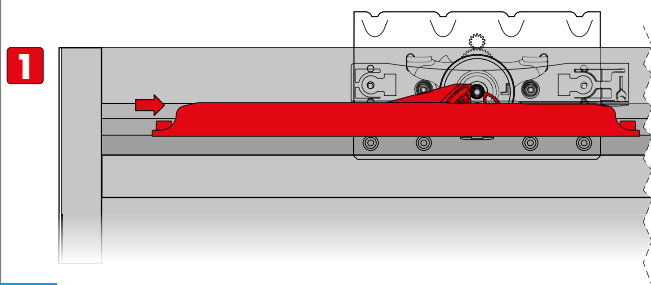

Den Dämpfer befestigen.

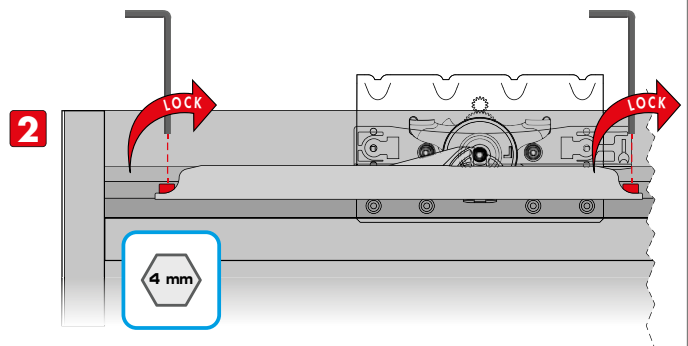

17b

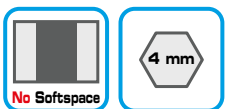

No Softspace

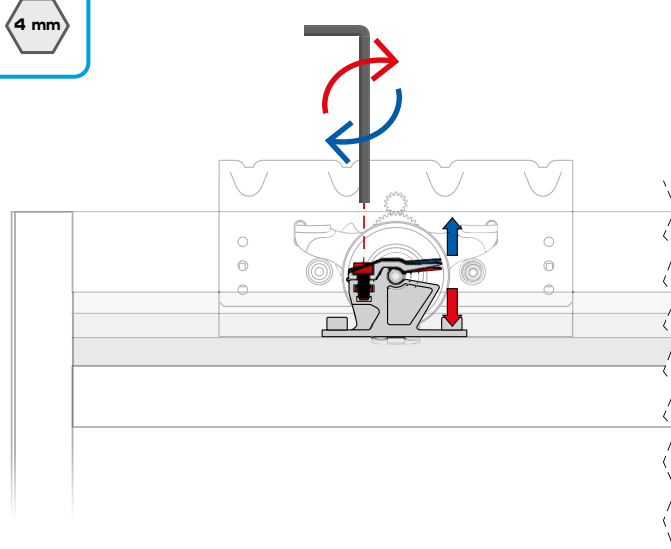

Die Einhackkraft der oberen Anschläge einstellen.

18